



# FREE FLOAT STEAM TRAP

## MODEL JH8RX

### FREE FLOAT STEAM TRAPS WITH THERMOSTATIC AIR VENTING

#### Features

A reliable and durable cast steel free float steam trap with tight shut-off for use on large-size process equipment.

1. Self-modulating free float provides continuous, smooth, low velocity condensate discharge as process loads vary.
2. Constant water-seal design ensures steam-tight seal, even under low-load conditions.
3. Only one moving part, the free float, eliminates concentrated valve wear and provides long maintenance-free service life.
4. Thermostatic capsule with "fail open" feature vents air automatically until close-to-steam temperature for rapid start-up, increased productivity and even heating.
5. Easy, inline access to internal parts simplifies cleaning and reduces maintenance costs.
6. Built-in screen with large surface area ensures trouble-free operation.



#### Specifications

Model	JHW8RX	JH8RX
Connection	Socket Welded	Flanged
Size (mm)	50, 80, 100	
Orifice No.	0.5, 1, 2, 5, 10, 14, 22, 32	
Maximum Operating Pressure (MPaG) PMO	0.05, 0.1, 0.2, 0.5, 1.0, 1.4, 2.2, 3.2	
Maximum Differential Pressure (MPa) ΔPMX	0.05, 0.1, 0.2, 0.5, 1.0, 1.4, 2.2, 3.2	
Minimum Operating Pressure (MPaG)	0.01	
Maximum Operating Temperature (°C) TMO	240	
Subcooling of X-Element Fill (°C)	up to 6	
Type of X-element	B	

PRESSURE SHELL DESIGN CONDITIONS (NOT OPERATING CONDITIONS): Maximum Allowable Pressure (MPaG) MPA: 4.6 1 MPa = 10.197 kg/cm<sup>2</sup>  
Maximum Allowable Temperature (°C) TMA: 425



To avoid abnormal operation, accidents or serious injury, DO NOT use this product outside of the specification range.  
Local regulations may restrict the use of this product to below the conditions quoted.

No.	Description	Material	JIS	ASTM/AISI*
①	Body	Cast Steel	SCPH2	A216 Gr. WCB
②	Cover	Carbon Steel	—	A105
③ <sup>F</sup>	Float	Stainless Steel	SUS316L	AISI316L
④ <sup>R</sup>	Orifice	Cast Stainless Steel	SCS2A	A217 Gr. CA15
⑤ <sup>MR</sup>	Orifice Gasket	Soft Iron	SUYP	AISI1010
⑥ <sup>MR</sup>	Outlet Cover Gasket	Stainl. St./Graphite	SUS304	AISI304
⑦ <sup>R</sup>	Screen	Stainless Steel	SUS430	AISI430
⑧	Screen Holder	Stainless Steel	SUS304	AISI304
⑨	Snap Ring	Stainless Steel	SUS304	AISI304
⑩ <sup>MR</sup>	Cover Gasket	Stainl. St./Graphite	SUS304	AISI304
⑪	Cover Bolt	Alloy Steel	SNB16	A193 Gr. B16
⑫	Cover Nut	Carbon Steel	S45C	AISI1045
⑬	Outlet Cover	Stainless Steel	SUS420J2	AISI420
⑭	Outlet Cover Bolt	Alloy Steel	SNB16	A193 Gr. B16
⑮	Outlet Cover Nut	Carbon Steel	S45C	AISI1045
⑯ <sup>X</sup>	X-element Case	Cast Stainless Steel	SCS13A	A351 Gr. CF-8
⑰ <sup>X</sup>	Snap Ring	Stainless Steel	SUS304	AISI304
⑱ <sup>X</sup>	X-element Screen	Stainless Steel	SUS304	AISI304
⑲ <sup>X</sup>	Spring Clip	Stainless Steel	SUS304	AISI304
⑳ <sup>X</sup>	X-element	Stainless Steel	—	—
㉑ <sup>X</sup>	Air Vent Valve Seat	Stainless Steel	SUS630	AISI630
㉒ <sup>MR</sup>	X-element Case Gasket	Soft Iron	SUYP	AISI1010
㉓	Nameplate	Stainless Steel	SUS304	AISI304
㉔	Screen Holder Retainer	Stainless Steel	SUS304	AISI304
㉕	Eye Bolt	Carbon Steel	SS400	A283 Gr. C
㉖	Flange	Cast Steel	—	A216 Gr. WCB
㉖	Socket	Carbon Steel	—	A105
㉗ <sup>MR</sup>	Drain Plug Gasket	Soft Iron	SUYP	AISI1010
㉘	Drain Plug	Carbon Steel	S25C	AISI1025

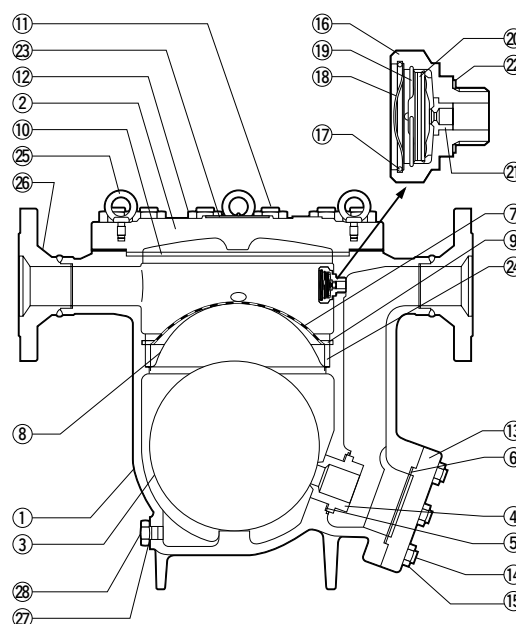

Copyright © TLV

\* Equivalent

Replacement kits available: (M) maintenance parts, (R) repair parts, (F) float, (X) X-element unit

**Dimensions**

● **JHW8RX**

Socket Welded

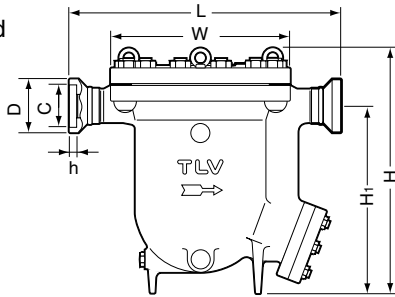

**JHW8RX** Socket Welded (mm)

Size	φD	φC	h	L	H	H <sub>1</sub>	φW	Weight (kg)
50	77.5	61.1	16	570	524	400	375	111
80	112	90.0		118				
100	140	115.3		124				

● **JH8RX**

Flanged

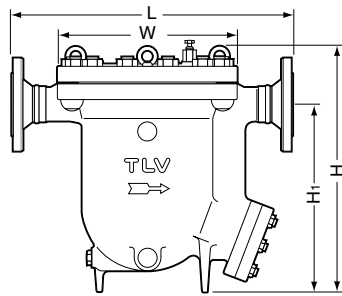

**JH8RX** Flanged (mm)

Size	L (ASME Class)			H	H <sub>1</sub>	φW	Weight (approx. kg)
	150RF	300RF	600RF				
50	591	597	616	524	400	375	120
80	588	598	617				130
100	570	596	622				149

Other standards available, but length and weight may vary

**Discharge Capacity**

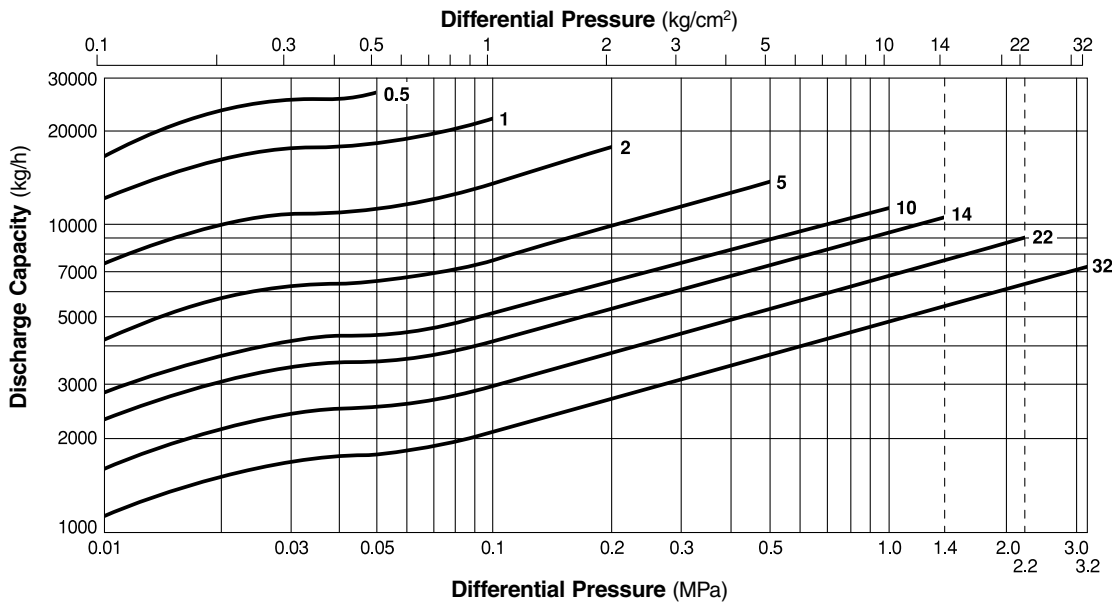

1. Line numbers within the graph refer to orifice numbers.
2. Differential pressure is the difference between the inlet and outlet pressure of the trap.
3. Capacities are based on continuous discharge of condensate 6 °C below saturated steam temperature.
4. Recommended safety factor: at least 1.5.

**CAUTION** DO NOT use traps under conditions that exceed maximum differential pressure, as condensate backup will occur!

Manufacturer

ISO 9001/ISO 14001

**TLV**® CO., LTD.  
Kakogawa, Japan

is approved by LRQA Ltd. to ISO 9001/14001

